

THIS DRAWING INCLUDING THE  
DESIGNS IS THE PROPERTY OF  
MESA MICROWAVE AND IS NOT TO BE  
USED FOR ANY PURPOSE  
WITHOUT OUR APPROVAL.

# W/G TO COAXIAL ADAPTER WR28 to K(F)

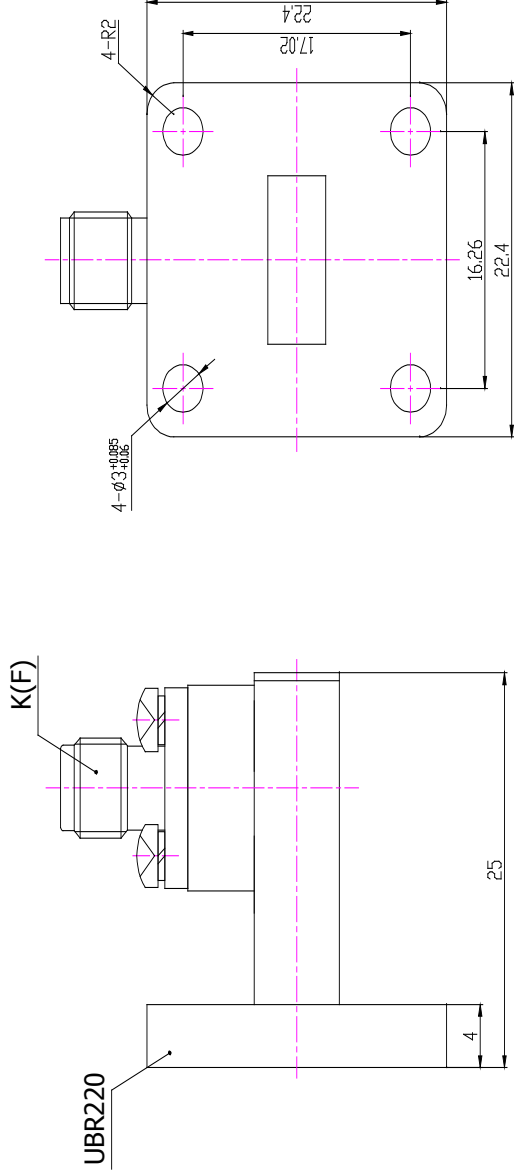

DIMENSIONS IN MM

## SPECIFICATIONS @ 25°C

Frequency Range: 26.5 to 40 GHz  
 Waveguide Type: WR28  
 Waveguide Flange: UG599/U  
 Waveguide Material: Copper  
 Insertion Loss: 0.30 dB Max  
 VSWR: 1.25:1 Max, 1.20:1 Typ  
 Connector: K(F)  
 Impedance: 50 Ohms  
 Oper Temp: -10C to +60C.

**Mesa** Microwave  
Corporation

2460 W. Ray Rd., Ste. 2 Chandler, AZ 85224  
 T. 480.890.1612 F. 480-890-2150  
 sales@mesamicrowave.com www.mesamicrowave.com

Your Source for R/F And Microwave Components

DESCRIPTION: **WR28 W/G TO COAX ADAPTER**

MODEL NO.:

**MMC-WGA-WR42-2.92mm(F)**

Drawn by:  
S.Smith

SIZE  
A

CAGE CODE:  
6L BG8

REV CODE: REV A

SCALE: N/A

ALL SPECIFICATIONS ARE SUBJECT TO  
CHANGE WITHOUT NOTICE AT ANY TIME

SHEET 1 OF 1